

To be presented at Committee
meeting scheduled for 6/11/19



Roberts Field Advisory Committee
June 11, 2019 Meeting

6/11/19

Meeting Agenda

- Public Input
- Shade Structure - Elisabeth
- Gate - Elisabeth
- Plans For Sandbox - Marcus
- Red Picnic Tables - Marcus
- State Funding Lobbying Update - Adelle
- 5 Senses Garden and Butterfly Garden Plant List - Sandie - Vote
- Climbing Rocks Removal Update - Bill
- Kinetic Sculpture Update – Bill
- Tree Tags Update - Bill
- Friends of Roberts Field Fundraising Update - Bill
- Roberts Field Funding Next Steps – Bill
- Discussion/Goals of Structure of the Committee - Denille
- RFAC Board Reorganization – Vote
- Room 205/CTM July Availabilities
- Adjourn



Public Input

Jim
Martin - A



NOTES:

1. THIS PLAN IS CONCEPTUAL ONLY AND IS NOT INTENDED FOR PERMITTING OR CONSTRUCTION.
2. THIS PLAN DEPICTS PHASE 1 AND PHASE 2 ITEMS IDENTIFIED BY THE ROBERTS FIELD IMPROVEMENT COMMITTEE.
3. WETLANDS FLAGGED BY TOWN CONSULTANT AND FIELD SURVEYED BY CHELMSFORD DPW.
4. WALKING PATH TO BE FOUR (4) FEET IN WIDTH AND MADE OF CRUSHER FINES. SEE DETAIL.

WALKING PATH ALTERNATIVES

WALKING PATH: 1,882LF
0.35 MI
FOREST WALKING PATH: +110LF
CONNECTOR PATH: +185LF

PARKING ADDITION

EXISTING: ± 98 SPACE
PROPOSED: 113 SPACES
LANDBANK: 4 SPACES

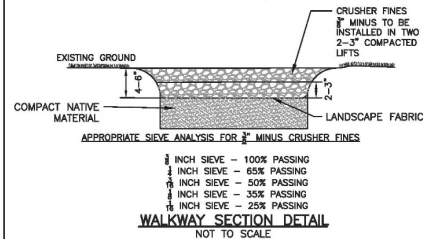
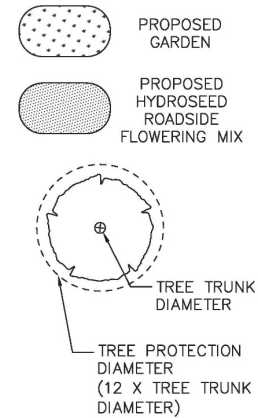

HOWARD STEIN HUDSON
114 Turnpike Road, Suite 2C
Chelmsford, MA 01824
www.hshassoc.com

PREPARED FOR:
TOWN OF CHELMSFORD
50 BILLERICA ROAD
CHELMSFORD, MA 01824

ROBERTS FIELD
MASTER PLAN
280 OLD WESTFORD ROAD
CHELMSFORD, MA 01824
MIDDLESEX COUNTY

REVISIONS:			
NO	BY	DATE	DESCRIPTION

CONCEPT

CONCEPT MASTER PLAN

DATE: 4-14-2016
PROJECT NUMBER: 15190
DESIGNED BY: HEG/KLE
DRAWN BY: HEG/KJF
CHECKED BY: KLE

41 SHEET 1 OF 1

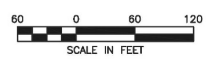

Jim
Martin - B

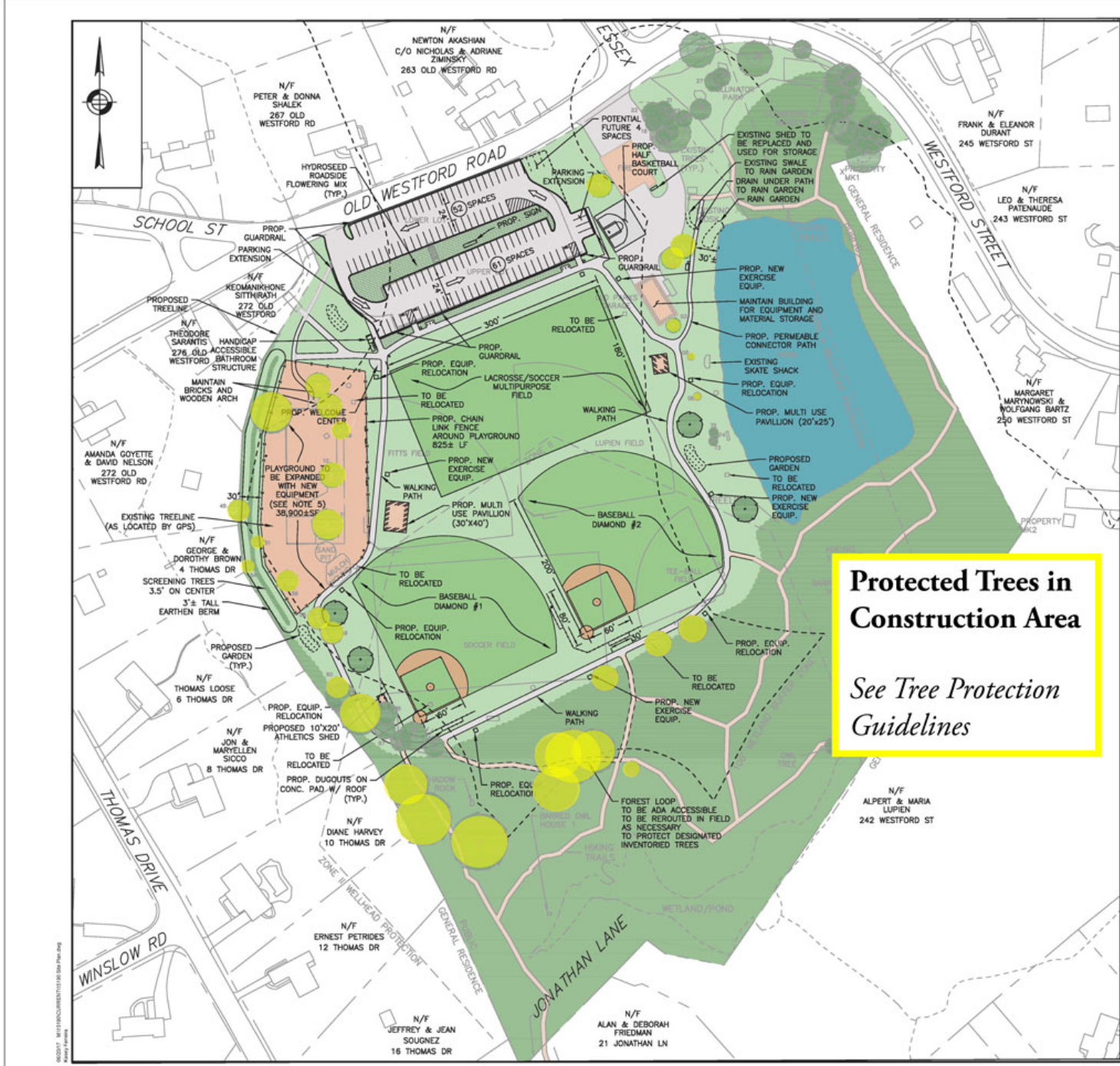

- NOTES:**
1. THIS PLAN IS CONCEPTUAL ONLY AND IS NOT INTENDED FOR PERMITTING OR CONSTRUCTION.
 2. WETLANDS FLAGGED BY TOWN CONSULTANT.
 3. WALKING PATH TO BE SIX (6) FEET IN WIDTH, MADE OF ASPHALT.
 4. CONNECTOR PATH AND FOREST LOOP TO BE FOUR (4) FEET IN WIDTH CONSTRUCTED WITH PERMEABLE SURFACE.
 5. PLAYGROUND TO BE DESIGNED IN BID PROCESS WITH NEW EQUIPMENT, NATURAL PLAY AREAS, VARIOUS SURFACES, AND SHADE STRUCTURES WITHIN THE MAXIMUM IDENTIFIED FOOTPRINT.
 6. ALL PROPOSED IMPROVEMENTS TO BE REROUTED OR REPOSITIONED AS NECESSARY TO PROTECT TREES.

WALKING PATH ALTERNATIVES
 WALKING PATH: 1,882LF
 FOREST WALKING PATH: +110LF
 CONNECTOR PATH: +185LF

PARKING ADDITION
 EXISTING: ± 98 SPACES
 PROPOSED: 113 SPACES
 LANDBANK: 4 SPACES

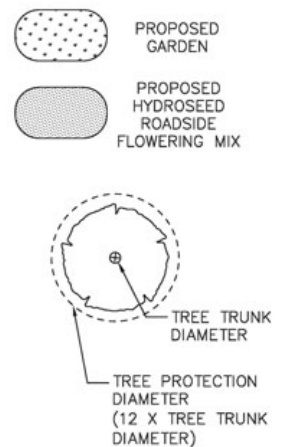

- LENDEND**
- WASTE BIN
 - BIKE RACK
 - BENCH
 - PICNIC TABLE
 - SHADE TREE
 - ⊙ SHRUBS
 - ⊙ PLANTINGS
 - ⊙ EXERCISE EQUIPMENT
 - ⊙ BOULDER



HOWARD STEIN HUDSON
 114 Turnpike Road, Suite 2C
 Chelmsford, MA 01824
 www.hshassoz.com

PREPARED FOR:
 TOWN OF CHELMSFORD
 80 BILLERICA ROAD
 CHELMSFORD, MA 01824

**ROBERTS FIELD
 MASTER PLAN**
 260 OLD WESTFORD ROAD
 CHELMSFORD, MA 01824
 MIDDLESEX COUNTY

REVISIONS:

NO	BY	DATE	DESCRIPTION
1	KF	06-16-17	PER COMMITTEE



CONCEPT

CONCEPT MASTER PLAN

DATE: 4-14-2016
 PROJECT NUMBER: 15190
 DESIGNED BY: HEG/KLE
 DRAWN BY: HEG/KJF
 CHECKED BY: KLE

Master Plan Recommendation Document

Jim
Martin - C



Master Plan Recommendation Document

Jim
Martin - D

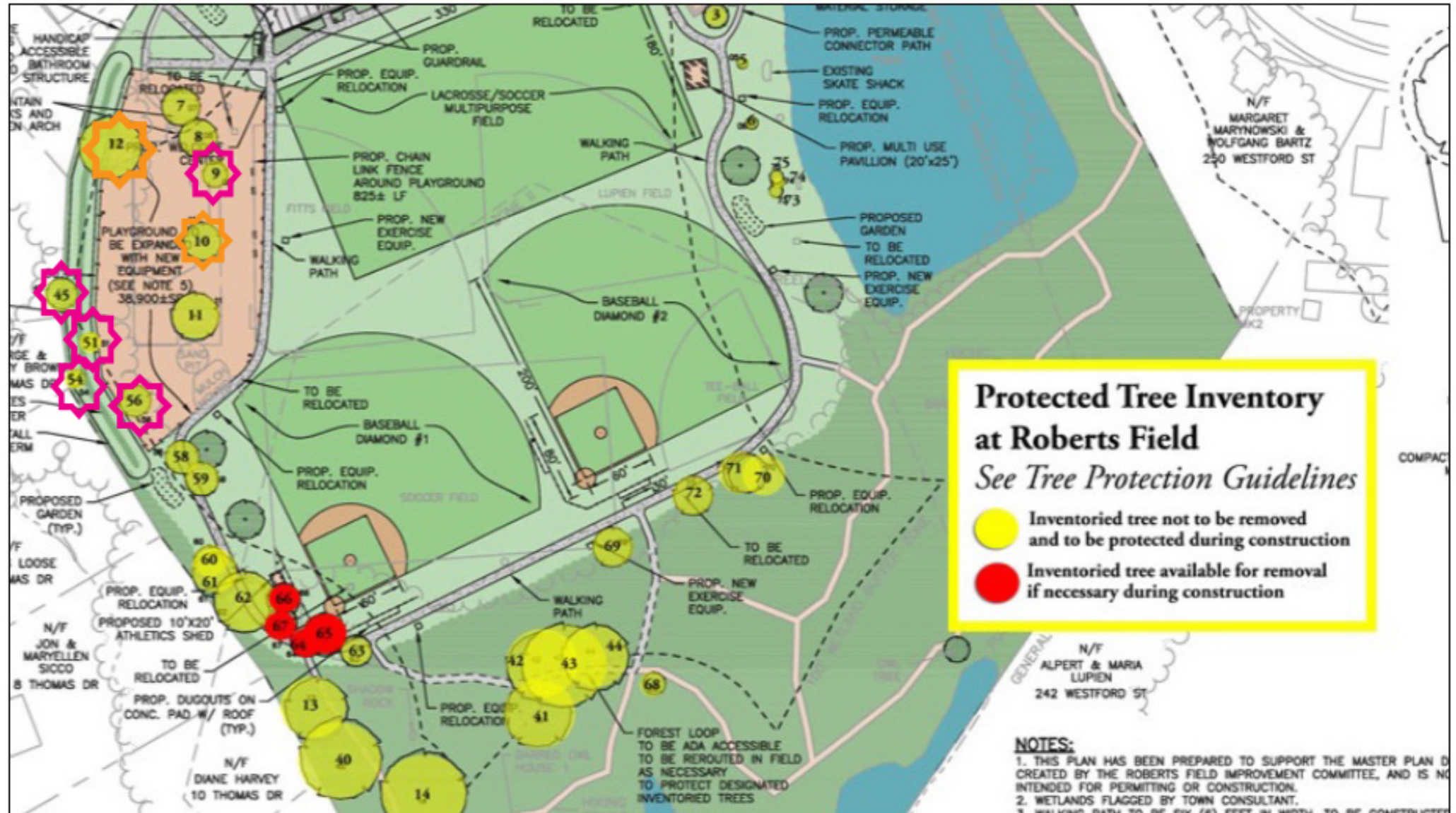

Removed Alive



Damaged

Public Input

Shade Structure - Elisabeth

Gate - Elisabeth

Plans For Sandbox - Marcus

Red Picnic Tables - Marcus

State Funding Lobbying Update - Adelle

- FY20 State Budget Amendment - \$50k
- Chapter 209 - \$500k

5 Senses Garden and Butterfly Garden Plant List - Sandie



GARDENING for BUTTERFLIES in New England

TO ATTRACT THE MOST BUTTERFLIES
TO YOUR GARDEN, PLANT BOTH NECTAR
FLOWERS AND CATERPILLAR FOOD
PLANTS

MY "TOP FIFTEEN" NECTAR PLANTS

Butterfly Bush* (*Buddleia davidii* . *B. alternifolia* is also good.)
Zinnias (tall, flat-topped varieties e.g. 'State Farm', 'Cut & Come Again', Carrousel. "Profusion" is okay. NOT pompoms.)
Marigolds (*Tagetes* spp.) (Taller, single varieties; NOT pompoms.)
Milkweeds: Swamp Milkweed (*Asclepias incarnata*), Butterfly Weed (*A. tuberosa*), and Common Milkweed (*A. syriaca*- aggressive).
New England Aster (*A. novae-angliae*), and most other asters.
Scabiosa* ('Butterfly Blue' lives up to its name.)
Purple Coneflower (and other *Echinacea* spp.)
New Jersey Tea (*Ceanothus americanus*)
Sweet Pepperbush (*Clethra alnifolia*) (all varieties)
Gayfeather (*Liatris* spp.) (*L. ligulistylis*, *pycnostachya*, *koboldii*, etc.)
Coreopsis spp. (Even 'Moonbeam' works for me)
Joe-Pye Weed (*Eupatorium* spp. – all varieties)
Cupplant or Compass Plant (*Silphium* spp.)
Mexican sunflower (*Tithonia*) (excellent in late summer)
Verbena: *V. bonariensis* in late summer and fall . Other verbenas okay.

ALSO GOOD: Chives (and other *Allium* spp.); *Senecio aureus* (wetland native for early bloom); Bee balm (*Monarda*); Thyme; Catmint* (*Nepeta*); Black-eyed Susan (*Rudbeckia*); Privet**; Dandelions**; Phlox; Centranthus*; Valerian*; Dogbane (caution: aggressive); vetch; thistles; Mountain-Mint (*Pycnanthemum* spp.); Mint (*Mentha* spp.) (caution: aggressive); Lilacs*; Cosmos; Sedums; Helenium; Blackberry; Raspberry; Lavender*; Galliardia; Red Clover*; Birds-foot Trefoil**; Button-bush (*Cephalanthus*); Black Cohosh (*Cimifuga racemosa*); Bidens (especially *Bidens alba*, which is annual in our climate); Lantana (not hardy); Pentas* (not hardy). For Moths: *Oenothera* spp.; *Nicotiana* spp.

*not native to the Americas, but well-behaved in our area **not native, may be aggressive

SOURCES FOR PLANTS AND SEEDS : Prairie Nursery; Prairie Moon Nursery
www.prairiemoonnursery.com ; Select Seeds www.selectseeds.com ; New England Wild

Flower Society www.newfs.org ; Churchill Nursery, Exeter, NH; Russell's Garden Center, Sudbury, MA; Bigelow Nurseries, Northboro, MA; Sunlight Gardens, TN; Johnnies Selected Seeds, Winslow, ME; and many others.

ESSENTIAL LARVAL FOOD PLANTS FOR YOUR GARDEN

Red Admiral: Nettles (*Urtica dioica***), False Nettle (*Boehmeria cylindrica*), Hops (*Humulus lupulus*)
American Lady: Pussytoes (*Antennaria*- all species); Pearly Everlasting (*Anaphalis margaritacea*); Cudweed (*Gnaphalium obtusifolium*, etc.); Globe Thistle (*Echinops ritro**).
Black Swallowtail: Dill (*Anethum graveolens**); Queen Anne's Lace (*Daucus carota***); Fennel (*Foeniculum vulgare***); Parsley (*Petroselinum**); Lovage (*Levisticum officinale**); Scotch Lovage (*Ligusticum scoticum*); Rue (*Ruta graveolens**).
Spicebush Swallowtail: Spicebush (*Lindera benzoin*); Sassafras
Monarch: Milkweeds (*Asclepias* spp) all, but especially Common Milkweed
Sulphurs, Eastern Tailed-Blue: Alfalfa*; Clovers*; Lespedeza, Desmodium, Lathyrus
Baltimore Checkerspot: Turtlehead (*Chelone glabra*); Plantain (*Plantago lanceolata*)
Pipevine Swallowtail: Dutchman's Pipe (*Aristolochia durior*)
Pearl Crescent: Asters; **Fritillaries:** Violets
Silver-spotted Skipper: Black locust (*Robinia*) (very aggressive); Honey locust (*Gleditsia*); Groundnut (*Apios americana*) (aggressive, but not as much as *Robinia*).
Viceroy: Poplars and Willows **Mourning Cloak:** Willows
Red-spotted Purple: Black Cherry (*Prunus serotina*); poplars, birches, willows
Eastern Comma; Question Mark; Milbert's Tortoiseshell: Stinging Nettles; Hops; Elms
American Copper: Sorrel, Dock (*Rumex* spp.)**
Spring/Summer Azure: Black Cherry (*Prunus serotina*); *Spirea*; *Vaccinium*
Least and Peck's Skippers: Grasses: *Poa* spp.; *Panicum* spp.
Crossline, Cobweb, and Dusted Skippers: Little Bluestem (*Schizachyrium scoparius*)

BUTTERFLY RESOURCES

Sharon Stichter, www.butterfliesofmassachusetts.net History of butterflies in our state, detailed host plant discussion, abundance charts, distribution maps. 2010.

Massachusetts Butterfly Club www.massbutterflies.org In-state photographs of all species, membership information, field trips, checklists, guide to good field sites.

Jeffrey Glassberg, *Butterflies Through Binoculars: The East*, Oxford University Press, 1993. The best field guide for our region.

Rick Cech, *Butterflies of the East Coast*, Princeton University Press, 2005. Beautiful up-to-date reference book; includes identification, host plants and habitat.

5 Senses Garden and Butterfly Garden Plant List - Sandie

How Every Garden Can Be a Butterfly Garden

Why do I want butterflies in my garden? First do you smile when you see a butterfly? They make us feel good. They add beauty and movement to our gardens.

And butterflies are useful to the environment in ways we don't see. As they flit from plant to plant, they pollinate many flowers and shrubs, just like bees.

Butterflies lay eggs that hatch to become caterpillars, and caterpillars are the preferred food for baby birds. No caterpillars, no food to feed the baby birds! Only 1% of all butterflies will survive the journey to adulthood.

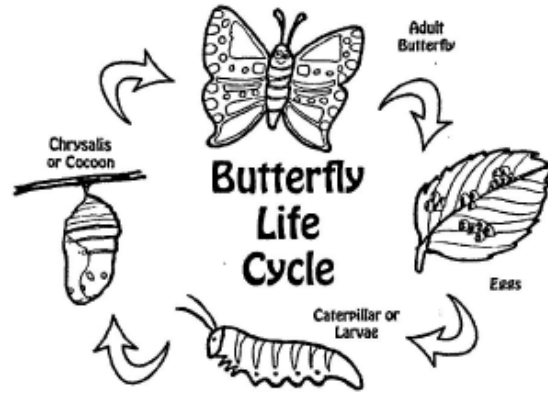

The life cycle of a butterfly can be as quick as a month or as long as a year. A female butterfly will lay eggs on a host plant where they hatch after about 5 days. What appears is a tiny worm – called a caterpillar – that immediately starts eating the leaves of the host plant. As they eat leaves, caterpillars grow quickly to many times their original size. They grow so rapidly they shed their skins four or more times in a short period.

Caterpillars are very vulnerable to birds who want to eat them, and to people spraying insecticides because “something” is eating their plant. So ask yourself, is the butterfly that evolves from the caterpillar worth a few chewed leaves to you?

When full grown, the caterpillar attaches itself to a leaf or small branch. It hangs upside down and then spins a cocoon around its body. This is called the chrysalis. It usually is the same color as its surroundings in hope that no one will notice it. Inside the chrysalis, the caterpillar rests and then begins the process to become a butterfly.

When the butterfly is fully formed, it emerges from its cocoon. It is exhausted from its work and again needs to rest, warm in the sun and pump blood into the soft wings so they harden into shape. A rock in the sun is a great place to warm up and get ready to fly. When the wings are ready, the butterfly flies off wobbly, it has to learn to fly without a teacher.

The butterfly will now go in search of plants that supply nectar, because nectar is what they live on. Eventually it will find a mate and then the female will find a host plant and lay her eggs. And the cycle starts over again!

If you plant host and nectar plants, you too will have butterflies.

Host plants include rose (or swamp) milkweed, black-eyed susans, coneflowers and dill. These all do double duty as nectar plants too. **Plants that provide just nectar** include annuals such as marigolds, zinnia and salvia as well as coreopsis, yarrow, liatris and asters. Different plants attract different butterflies. To find more information on butterflies, go to www.xerces.org.

5 Senses Garden and Butterfly Garden Plant List - Sandie

- Plant supplier info:
- Mahoney's will give us 1/3 off our purchases, where Weston nursery is 30% off.
- Jack Wagner at Weston Nursery is working on a layout for the perennial garden. It is their busy season now.
- Dicks Market Gardens & Greenhouses in Lunenburg has a great selection of perennials and herbs. Waiting for a call back on a discount. (A favorite)
- McCue Garden Center in Woburn.
- Great selection of plants!
- Waiting on a call back from Megan about a donation or a discount. (A favorite)
- I asked in Lowe's. There is a program in the Spring that we can apply for, the "Hero's Project"
- If we get it, they will donate all the plants and labor.
- Contact store manager Mike Nordstrom from details.
- ***Maybe Denille can do this.
- If we want plants now, (perennials), we need to buy them in the next few weeks for late summer planting or they will all be picked over. Just need a place to hold them. (I can't)
- Last year I think Mahoney's said they could.
- Herbs will have to wait till next spring as most are only annuals.
- Too many to list!

Climbing Rocks Removal Update - Bill

- Climbing Rocks removed by DPW after safety inspection and follow-up with Town's Insurer
 - Commercial equipment only for play
 - Stone does not meet ASTM safety standards



April 11, 2019

Friendship Park at Roberts Field
Attention: Steve Callaghan
270 Old Westford Road
Chelmsford, MA 01824

Dear Steve,

Enclosed is the safety inspection report that I conducted last week. Overall you are in good shape and the head entrapment I found on the large composite structure is already being addressed. A couple of items I want to address that we discussed;

1. The rocks that were installed in area # 1. The rocks that were installed are not commercial play equipment therefore I cannot write off on them as being compliant. All commercial playground equipment must be approved by the ASTM before being sold in the market. I know the intentions were good when you installed these rock's, but I cannot accept them as playground equipment. They should be removed for liability reasons.
2. The signs that you received from Landscape Structures need to be located where there is the best visibility. The users need to be able to see them and understand which age group the equipment is intended for.
3. Finally, I strongly suggest that the 2 garden areas in the play area which have the ornaments have signs installed stating that these areas are not play areas and to stay off.

Otherwise the playground is beautiful and hope you have years of success with it. It was great meeting you!

Sincerely,

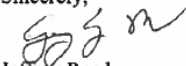
Jeffrey Reed
Playground Medic

From: Mark Januskiewicz <Mark.Janusiewicz@cabotrisk.com>

Sent: Monday, April 29, 2019 8:16 AM

To: Erica Citro <Erica.Citro@cabotrisk.com>

Subject: RE: Town of Chelmsford - Opinion on liability risk

Hi Erica,

The U.S. Consumer Product Safety Commission (CPSC) develops safety guidelines for commercial and home playground equipment. ... These standards are voluntary and are not required by law, but they are designed to help keep children safer on play areas.

The CPSC standard states under Playground Surfacing:

2.4 Surfacing

The surfacing under and around playground equipment is one of the most important factors in reducing the likelihood of life-threatening head injuries.

A fall onto a shock absorbing surface is less likely to cause a serious head injury than a fall onto a hard surface. However, some injuries from falls, including broken limbs, may occur no matter what playground surfacing material is used.

The most widely used test method for evaluating the shock absorbing properties of a playground surfacing material is to drop an instrumented metal headform onto a sample of the material and record the acceleration/time pulse during the impact. Field and laboratory test methods are described in ASTM F1292 *Standard Specification for Impact Attenuation of Surface Systems Under and Around Playground Equipment.*

Based on the CPSC guidelines, I agree with the report from the Playground Medic stating the rocks do not meet ASTM safety standards.

Regards,

Mark Januskiewicz
Risk Management Representative
MIIA Member Services
Cabot Risk Strategies LLC
15 Cabot Road, Woburn, MA 01801

Kinetic Wind Sculpture - Bill

- Built by Chris Ferreira and Joe McCarthy
- Volunteer installation
- Plan being reviewed by DPW

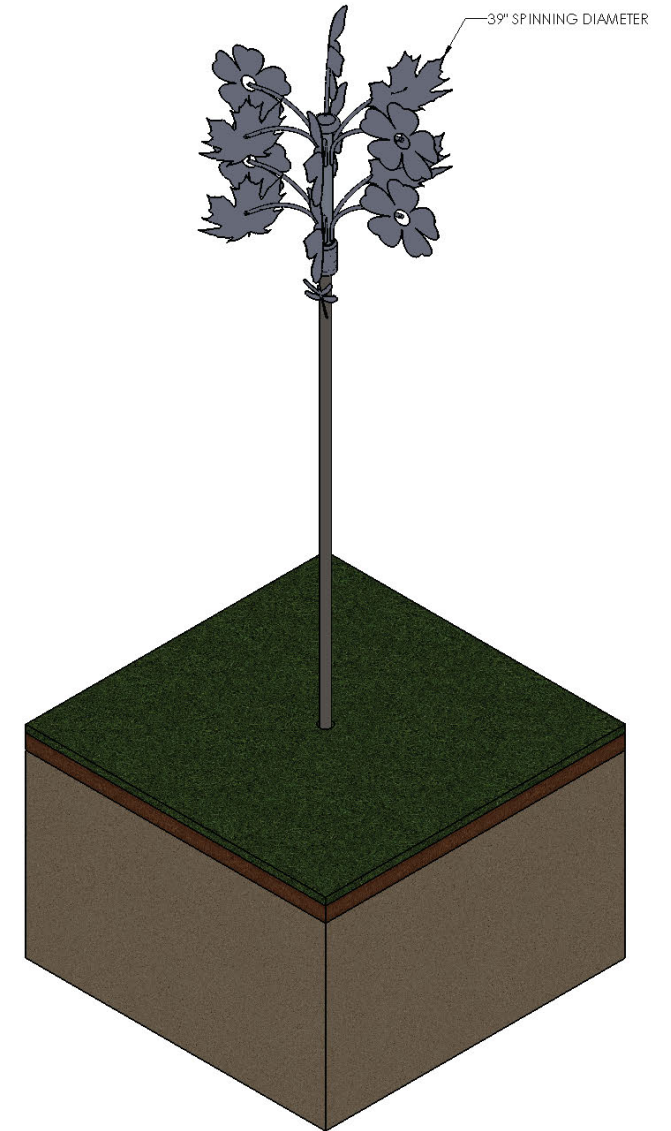
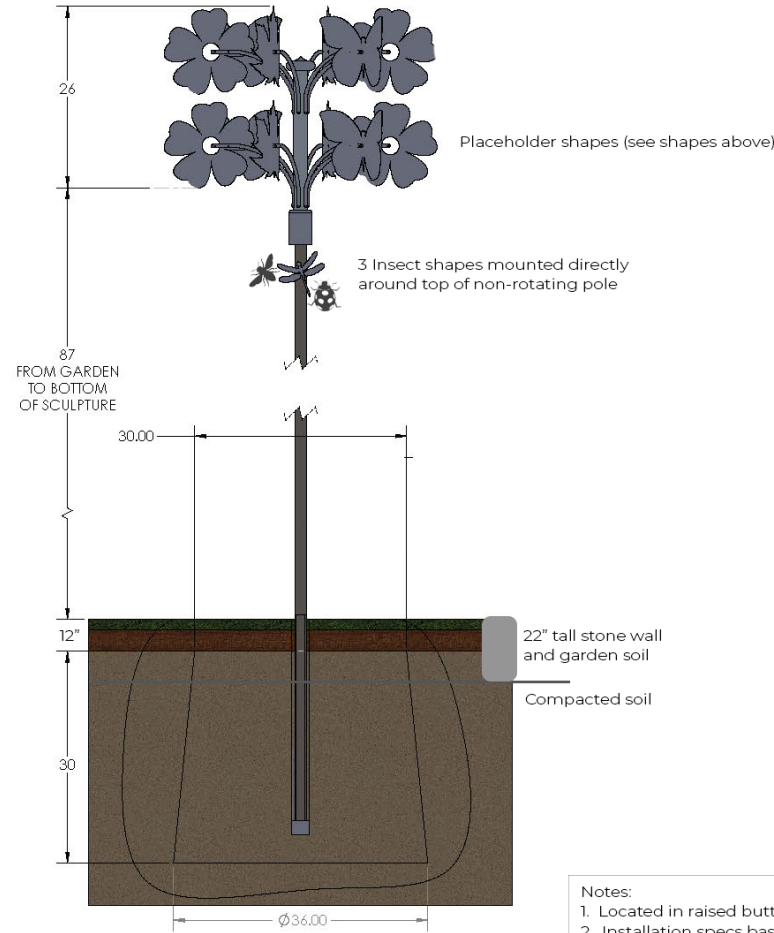
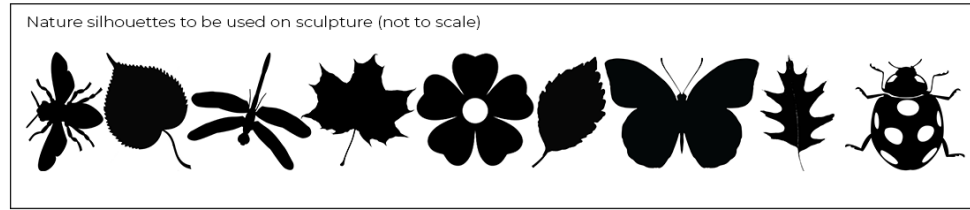

- Notes:
1. Located in raised butterfly garden in rear of playground (12' x 8')
 2. Installation specs based on 30' commercial flagpole mounting specs
 3. Top rotates on magnets and teflon sleeve on steel pipe
 4. Center steel pipe filled with concrete
 5. Pipe embedded in conical shaped concrete footing (majority in compacted soil)
 6. Shapes laser cut from aluminum sheeting and welded to steel arms
 7. Tall (4'+) perennial plantings at pole base
 8. Finishing plan TBD

Tree Tags Update - Bill

- 12 Tree Tags to be engraved
- Tree Committee to fund and install
- Fact Sheets completed and uploaded to Town server

Eastern White Pine
SCIENTIFIC NAME: *Pinus Strobus* L.
FAMILY: Pinacea
MORE INFO: <https://tinyurl.com/y6crqhl5>



ROBERTS FIELD



4
TREE WALK
Courtesy of the
Chelmsford Tree Committee

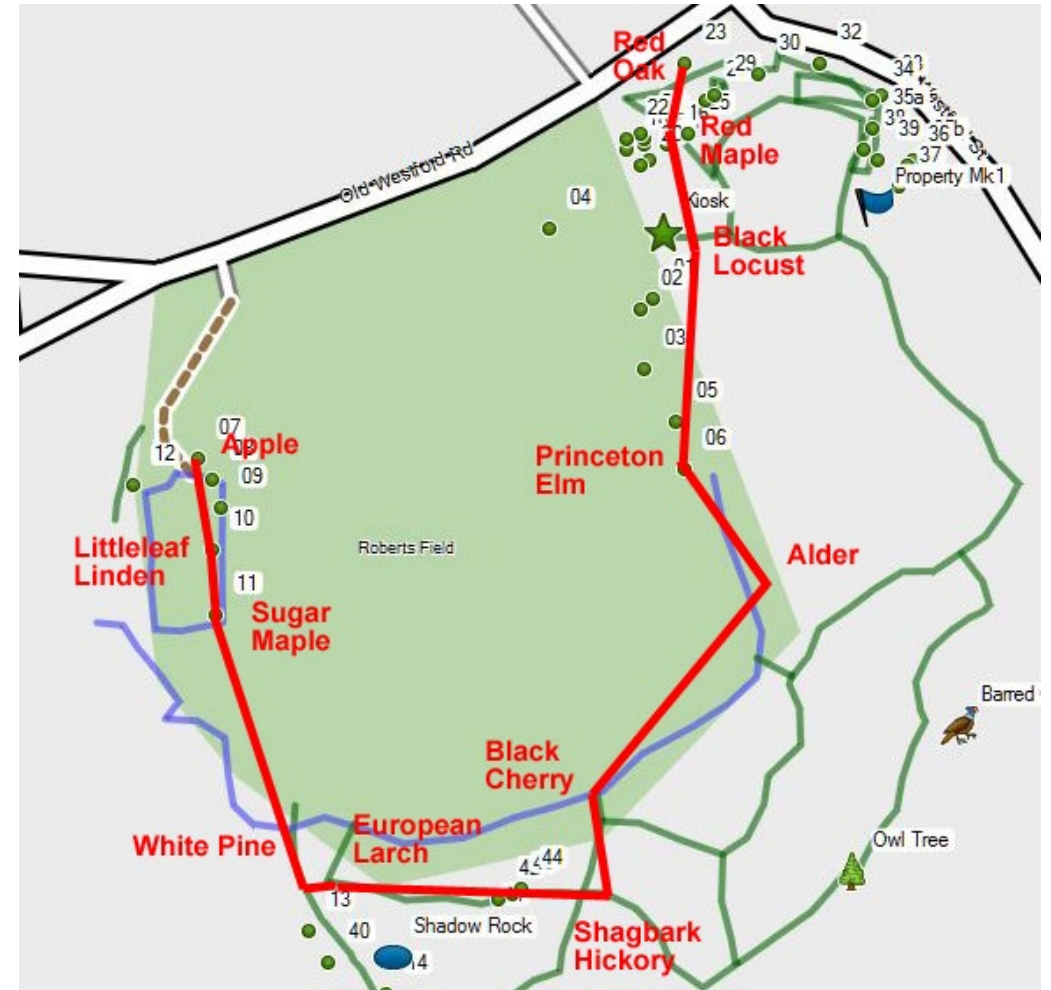

FORF Fundraising Update - Bill

- Friends of Roberts Field
 - Provided nearly a third of total playground project value
 - 42 playground sponsorships
 - 941 bricks sold
- To date, \$86k paid to the Town
 - Approximately \$30k to be used for debt service of CPA bond at Spring Town Meeting
 - Town will accept funds through March 2020
 - \$4.4k more now available



Town CPA Account Expenditures	\$ 449,098.08
Town Revolving Account Expenditures	\$ 55,577.90
Total Town Expenditures	\$ 504,675.98
Planned Additional Town Expenditures	\$ 7,300.00
Total Town Playground Expenditures	\$ 511,975.98
Volunteer Sweat Equity	\$ 40,000.00
DPW Sweat Equity	\$ 75,000.00
Total Playground Value	\$ 626,975.98
FORF Funds Raised To Date	\$ 116,813.20
FORF In-kind Donations To Date	\$ 13,413.00
	\$ 130,226.20
FORF Value Add To Date	\$ 170,226.20
	27%

Roberts Field Funding Next Steps - Bill

- From the Town Manager:

The state budget is expected to be completed in July. Over the summer, I plan to examine the possibility of seeking funding at the Fall Annual Town Meeting for a next phase of improvements at Roberts Field. Any moneys included in the state budget would be incorporated into the next phase plan. It would be helpful for the Committee to provide me with an updated prioritization of the future phases of improvements along with the respective costs.

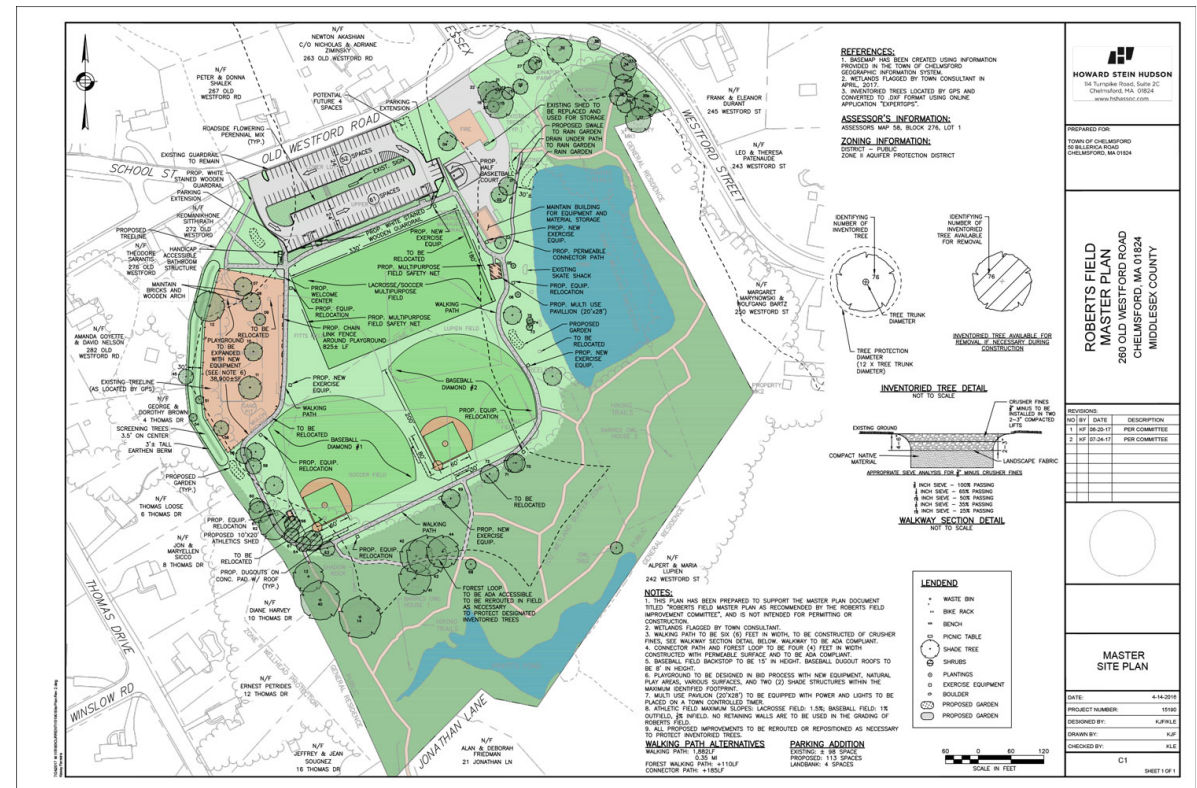

Fall Town Meeting begins October 21, 2019

Discussion/Goals of Structure of the Committee - Denille

RFAC Board Reorganization – Vote

- New Board with new Committee Member terms (June 3rd)
- Board nominations and Vote
 - Chair & Clerk – Mandatory
 - Chair – Bill does not intend to continue
 - Clerk – Justin does not intend to continue
 - Vice Chair - Optional



ROBERTS FIELD
C H E L M S F O R D M A

July – Room 205/CTM Available Dates

- Tuesday, July 9
- Monday, July 15
- Wednesday, July 17
- Thursday, July 18
- Monday, July 22
- Tuesday, July 23
- Thursday, July 25
- Tuesday, July 30
- Wednesday, July 31