

# Leave Your Mark At Friendship Park. Buy A Brick Today!

To benefit the new playground. Personally engraved, two brick sizes, family-friendly prices (\$50/\$100), onscreen brick designer, and easy pay with credit card or check.

*Hurry offer Ends 4/30/18*



[www.FriendsofRobertsField.org/Buy-A-Brick](http://www.FriendsofRobertsField.org/Buy-A-Brick)

**Have Fun!  
Friendship Park**

**The Friends  
of  
Roberts Field**



# Roberts Field Advisory Committee

## *February 27, 2018 Public Input Session*

2/26/18

*To be presented at Public Input Session at  
Chelmsford Senior Center scheduled for 2/27/18*

# Public Input Session Agenda

- Welcome
- Presentation of New Friendship Park Playground Design
  - Meghan O'Brien – President, O'Brien and Sons
  - Steve Jahnle – Assistant Director, Department of Public Works
- Playground Design and Construction Timeline
- Fundraising and Volunteer Updates
- Public Input
- Adjourn Meeting



FRIENDSHIP PARK  
AT ROBERTS FIELD



# Design Highlights

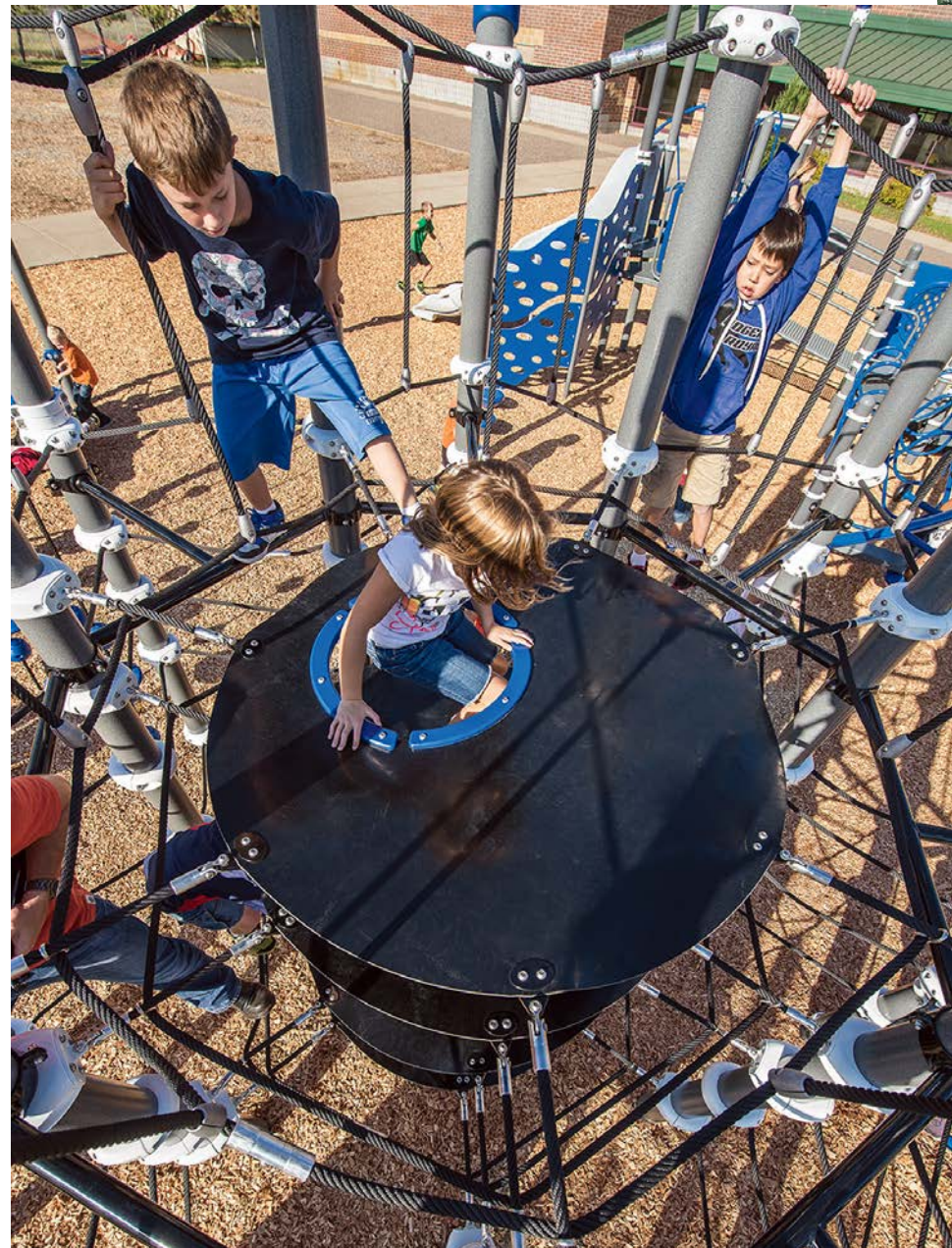

2100 sq/ft  
Poured in  
Place  
Rubber  
Pathways  
and Access  
Points















# ROBERTS FIELD

CHELMSFORD, MA February 26, 2018 112633-1-2-1





# ROBERTS FIELD

CHELMSFORD, MA February 26, 2018 112633-1-2-4





# ROBERTS FIELD

CHELMSFORD, MA February 26, 2018 112633-1-2-2





# ROBERTS FIELD

CHELMSFORD, MA February 26, 2018 112633-1-2-3





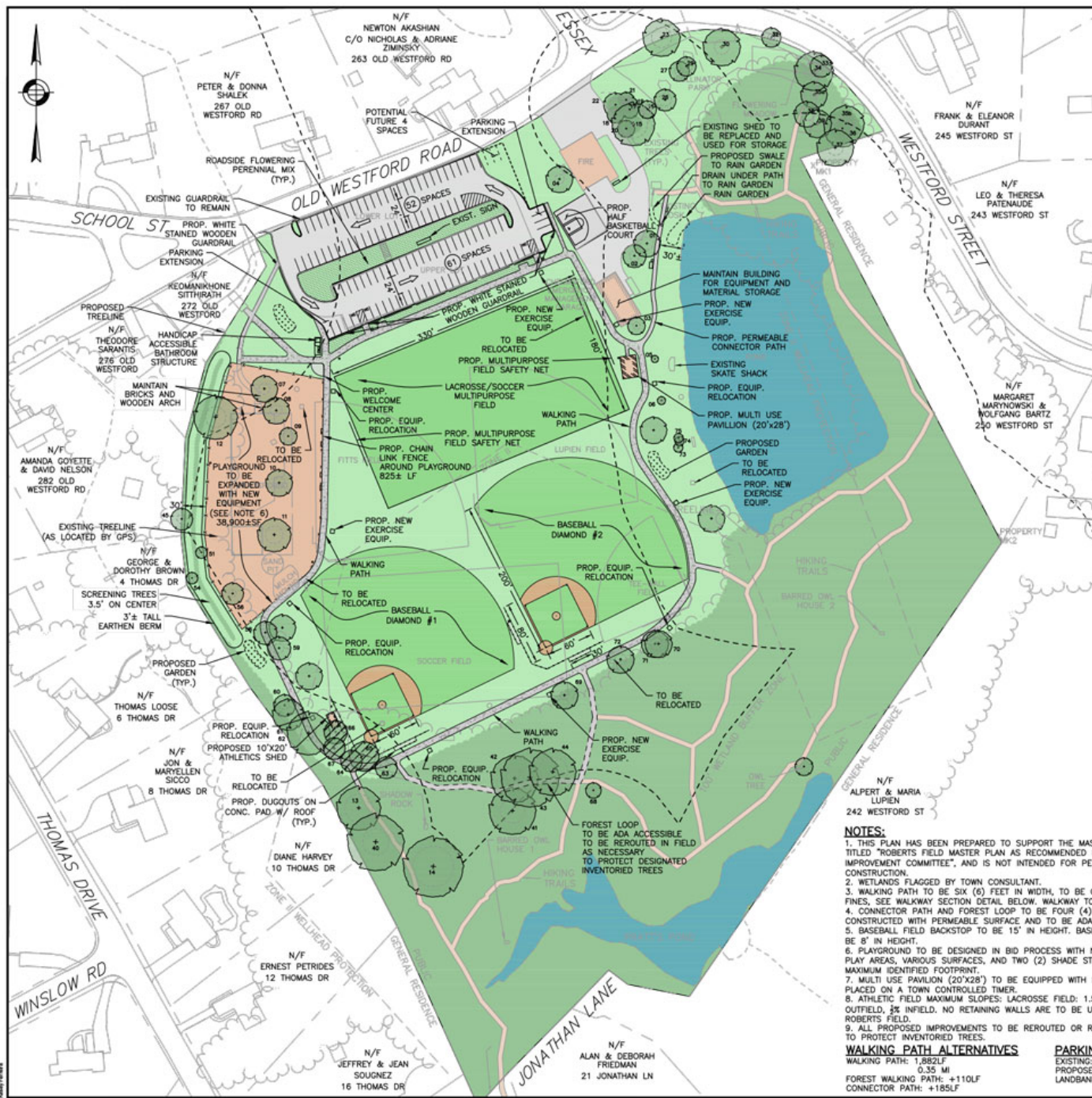

**REFERENCES:**  
 1. BASEMAP HAS BEEN CREATED USING INFORMATION PROVIDED IN THE TOWN OF CHELMSFORD GEOGRAPHIC INFORMATION SYSTEM.  
 2. WETLANDS FLAGGED BY TOWN CONSULTANT IN APRIL, 2017.  
 3. INVENTORIED TREES LOCATED BY GPS AND CONVERTED TO .DXF FORMAT USING ONLINE APPLICATION "EXPERTGPS".

**ASSESSOR'S INFORMATION:**  
 ASSESSORS MAP 58, BLOCK 276, LOT 1

**ZONING INFORMATION:**  
 DISTRICT - PUBLIC  
 ZONE II AQUIFER PROTECTION DISTRICT

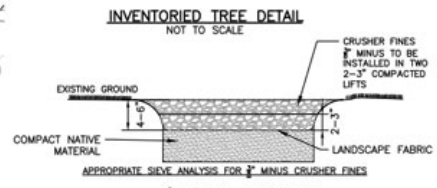
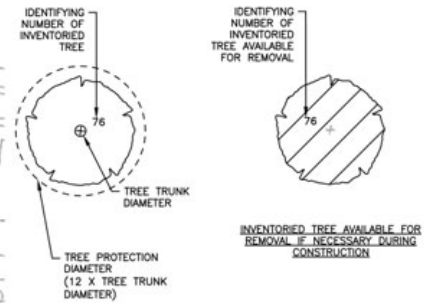

- 1/2" INCH SIEVE - 100% PASSING
  - 3/8" INCH SIEVE - 65% PASSING
  - 1/4" INCH SIEVE - 50% PASSING
  - 3/16" INCH SIEVE - 35% PASSING
  - 1/8" INCH SIEVE - 25% PASSING
- WALKWAY SECTION DETAIL**  
 NOT TO SCALE

- LENDEND**
- WASTE BIN
  - BIKE RACK
  - BENCH
  - PICNIC TABLE
  - SHADE TREE
  - SHRUBS
  - PLANTINGS
  - EXERCISE EQUIPMENT
  - BOULDER
  - PROPOSED GARDEN
  - PROPOSED GARDEN

**NOTES:**  
 1. THIS PLAN HAS BEEN PREPARED TO SUPPORT THE MASTER PLAN DOCUMENT TITLED "ROBERTS FIELD MASTER PLAN AS RECOMMENDED BY THE ROBERTS FIELD IMPROVEMENT COMMITTEE", AND IS NOT INTENDED FOR PERMITTING OR CONSTRUCTION.  
 2. WETLANDS FLAGGED BY TOWN CONSULTANT.  
 3. WALKING PATH TO BE SIX (6) FEET IN WIDTH, TO BE CONSTRUCTED OF CRUSHER FINES, SEE WALKWAY SECTION DETAIL BELOW. WALKWAY TO BE ADA COMPLIANT.  
 4. CONNECTOR PATH AND FOREST LOOP TO BE FOUR (4) FEET IN WIDTH CONSTRUCTED WITH PERMEABLE SURFACE AND TO BE ADA COMPLIANT.  
 5. BASEBALL FIELD BACKSTOP TO BE 15' IN HEIGHT. BASEBALL DUGOUT ROOFS TO BE 8' IN HEIGHT.  
 6. PLAYGROUND TO BE DESIGNED IN BID PROCESS WITH NEW EQUIPMENT, NATURAL PLAY AREAS, VARIOUS SURFACES, AND TWO (2) SHADE STRUCTURES WITHIN THE MAXIMUM IDENTIFIED FOOTPRINT.  
 7. MULTI USE PAVILION (20'x28') TO BE EQUIPPED WITH POWER AND LIGHTS TO BE PLACED ON A TOWN CONTROLLED TIMER.  
 8. ATHLETIC FIELD MAXIMUM SLOPES: LACROSSE FIELD: 1.5%; BASEBALL FIELD: 1% OUTFIELD, 3% INFIELD. NO RETAINING WALLS ARE TO BE USED IN THE GRADING OF ROBERTS FIELD.  
 9. ALL PROPOSED IMPROVEMENTS TO BE REROUTED OR REPOSITIONED AS NECESSARY TO PROTECT INVENTORIED TREES.

**WALKING PATH ALTERNATIVES**  
 WALKING PATH: 1,852LF  
 0.35 MI  
 FOREST WALKING PATH: 4110LF  
 CONNECTOR PATH: +185LF

**PARKING ADDITION**  
 EXISTING: ± 98 SPACE  
 PROPOSED: 113 SPACES  
 LANDBANK: 4 SPACES



**HOWARD STEIN HUDSON**  
 114 Turnpike Road, Suite 2C  
 Chelmsford, MA 01824  
 www.hshassoc.com

PREPARED FOR:  
 TOWN OF CHELMSFORD  
 50 BILLERICA ROAD  
 CHELMSFORD, MA 01824

**ROBERTS FIELD  
 MASTER PLAN**  
 260 OLD WESTFORD ROAD  
 CHELMSFORD, MA 01824  
 MIDDLESEX COUNTY

**REVISIONS:**

NO	BY	DATE	DESCRIPTION
1	KF	06-20-17	PER COMMITTEE
2	KF	07-24-17	PER COMMITTEE

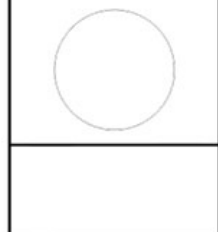

**MASTER SITE PLAN**

DATE: 4-14-2016  
 PROJECT NUMBER: 15190  
 DESIGNED BY: KJFKLE  
 DRAWN BY: KJF  
 CHECKED BY: KLE



# Roberts Field Advisory Committee

## Design and Construction Milestones - draft

Timing (2018)	Project Milestones
January 29 - Monday	BOS Meeting: Award Contract – <i>BOS/Town Manager Approval</i>
Feb 6 – Tuesday 10am	Playground Design Working Session (DPW, RFAC, O’Brien and Sons)
Feb 12 6pm-7pm	Public Input Session – First Draft of the Playground Design
Feb 12 – Monday 7pm	Roberts Field Advisory Committee Meeting – Town Offices, Room 205
Feb 20 - Tuesday 7pm	Roberts Field Advisory Committee Meeting – Town Offices, Room 205
Feb 27 – Tuesday 6pm	Public Input Session
March 9 - Friday	Finalize Playground Design - <i>Town Manager Approval</i>
March 16 - Friday	Purchase New Equipment (4-6 weeks delivery)
March 2018	Begin Corporate Sponsorship and Grant Writing
April 30 - Monday	End Carved Brick Fundraising Campaign
May - Month	Site Prep
April 30 - Monday	Equipment Delivery
June 2 & 3 – Sat/Sun	Community Build
June 23, 2018 - Saturday	Playground Grand Opening



# Fundraising and Volunteer Update

- Friends of Roberts Field is fundraising for the new playground
- Fundraising Goal \$100k+
  - Buy A Brick, Sponsorships and Grants
  - We Need Your Help Now! Please sign up tonight
    - Phone calls, posting flyers, sending emails, grant writing and more
- Community Build (June 2 & 3)
  - 50 volunteers needed per day
  - Project savings - \$40k
- [www.FriendsofRobertsField.org](http://www.FriendsofRobertsField.org)







**FRIENDSHIP PARK**  
A T R O B E R T S F I E L D

Please fill out a comment card.

*Thank you!*